

Junior Height Bottle Filling Fountain

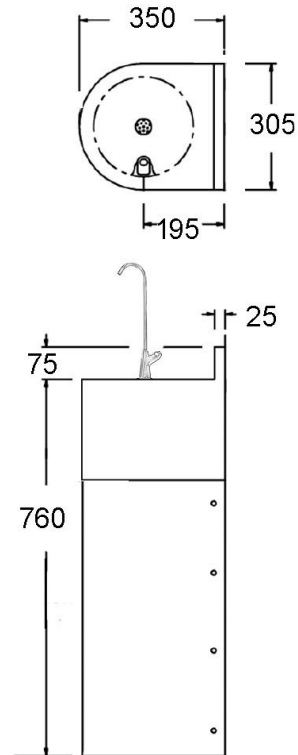

Product Code: DFFSJ-CF

Junior Height Bottle Filling Fountain

Product Code DFFSJ-CF

The cup and bottle filling station is wall and floor mounted at junior height, and provides a safe solution for younger children to refill water bottles and cups.

The timed flow filler is activated by press button which turns off when released preventing water wastage. The self closing valve allows younger users to use the filler fountains unsupervised without the risk of leaving the tap running.

The junior height bottle filling fountains and shrouds are produced from grade 304 1.6mm thick stainless steel for durability and resistance to vandalism. The removable shroud is held on with security screws and conceals the waste and supply pipework for safety.

Polished to a satin finish the junior height bottle and cup filling station is easily cleaned, whilst the smooth radius design helps prevent injury associated with sharp corners.

The bottle filling fountain provides easy access to safe drinking water, where younger children are able to re-fill their sports bottles, promoting the benefits of hydration at an early age.

To ensure the proper functioning and longevity of this unit, a Y-strainer or filter must be installed as part of the water supply system. The Y-strainer / filter is essential for protecting the internal components and maintaining the correct flow characteristics of the tap. Failure to install a Y-strainer or filter will result in the warranty being void.

Dimensions & Specifications:

Width: 305mm.

Depth: 350mm from wall.

Height: 760mm plus 75mm rear upstand.

Cup and Bottle Filler height: Spout height 247mm - 290mm overall height.

Material: 1.6mm thick grade 304 stainless steel.

Bottle filler: WRAS approved [Swan neck push button bottle filling tap](#).

Recommended Mounting Heights For Bottle Filling Stations:

Adult: 900 to 915mm.

Junior: 762mm.

Infant: 690mm.

Secondary: 860mm.

Supplied With:

Integral wall fixing brackets.

32mm flush grated waste fitting.

Standard chrome plated swan neck cup / bottle filler with self closing valve and 15mm water pipe compression coupler.

Delivery:

In stock, usually delivered in one to two working days.

Optional Fountain Extras:

[McAlpine plastic 32mm bottle trap.](#)

**All pictures shown are for illustration purpose only and may be subject to change without notice. Actual product may vary due to product enhancement.
All dimensions shown are for guidance only and may be subject to change or alteration without notice. All items manufactured or purchased separately from a third party to fit our products should be checked against the actual dimensions of the physical product before purchase. We will not be liable for third party costs and consequential loss associated with the items not fitting third party components.**