

## Adult Height Bottle Filling Fountain

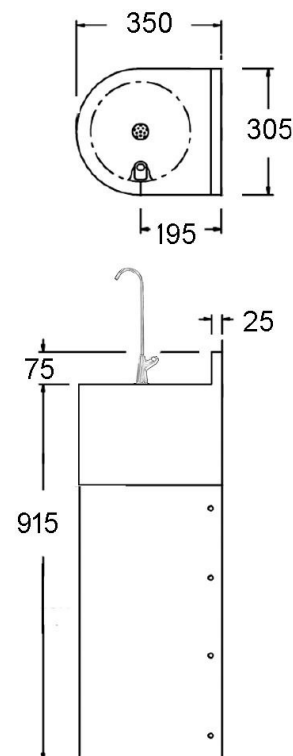

Product Code: DFFSA-CF

### Adult Height Bottle Filling Station

Product Code DFFSA-CF

The stainless steel adult height bottle and cup filling fountain is wall and floor mounted and provides a strong, attractive, easily cleaned solution for delivering drinking water.

The press button time flow swan neck filler is located away from the back wall making it easier for the user to fill cups and bottles. The self closing valve prevents water wastage.

Manufactured from 1.6mm thick grade 304 stainless steel with a full adult height shroud the bottle and cup filling station is very robust and resistant to vandalism. The removable shroud conceals the waste and supply pipework for extra vandal resistance and safety and is retained by security screws.

Polished to a satin finish the adult height bottle filling station is easily maintained ensuring a long lasting finish. The smooth radius design helps prevent injuries associated with sharp corners, and along with the 75mm rear upstand aids cleaning which improves hygiene. The compact design allows the bottle filler station to be easily installed in any suitable location.

Providing accessible drinking water promotes hydration leading to better health, and improved mental performance in schools and the workplace.

To ensure the proper functioning and longevity of this unit, a Y-strainer must be installed as part of the water supply system. The Y-strainer is essential for protecting the internal components and maintaining the correct flow characteristics of the tap. Failure to install a Y-strainer will result in the warranty being void.

### Dimensions & Specifications:

Width: 305mm.

Depth: 350mm from wall.

Height: 915mm plus 75mm rear upstand.

Bottle and Cup Filler height: Spout height 247mm - 290mm overall height.

Material: 1.6mm thick grade 304 stainless steel.

Bottle filler: WRAS approved [Swan neck push button bottle filling tap](#).

### Recommended Mounting Heights For Bottle Filling Fountains:

Adult: 900 to 915mm.

Junior: 762mm.

Infant: 690mm.

Secondary: 860mm.

### Supplied With:

Integral wall fixing brackets.  
32mm flush grated waste fitting.  
Standard chrome plated swan neck cup / bottle filler with self closing valve and 15mm water pipe compression coupler.

**Delivery:**

In stock, usually delivered in one to two working days.

**Optional Fountain Extras:**

[McAlpine plastic 32mm bottle trap.](#)

**\*\*All pictures shown are for illustration purpose only and may be subject to change without notice. Actual product may vary due to product enhancement.**  
All dimensions shown are for guidance only and may be subject to change or alteration without notice. All items manufactured or purchased separately from a third party to fit our products should be checked against the actual dimensions of the physical product before purchase. We will not be liable for third party costs and consequential loss associated with the items not fitting third party components.\*\*